



3803 Oceanic Drive  
Ste 201  
Oceanside, CA 92056  
Phone: 760-842-8300  
Fax: 760-842-8306  
www.electrosport.com

## AceWell Speed Sensor Fitting Instructions

**APPLICATIONS:** Universal / Motorcycles

### Read these instructions completely

**Step 1.** Position the sensor loose fitting it to the front brake caliper. It is important to see the alignment location for the sensor to the brake caliper and also where the rotor will pass over the sensor. **See Figure A**

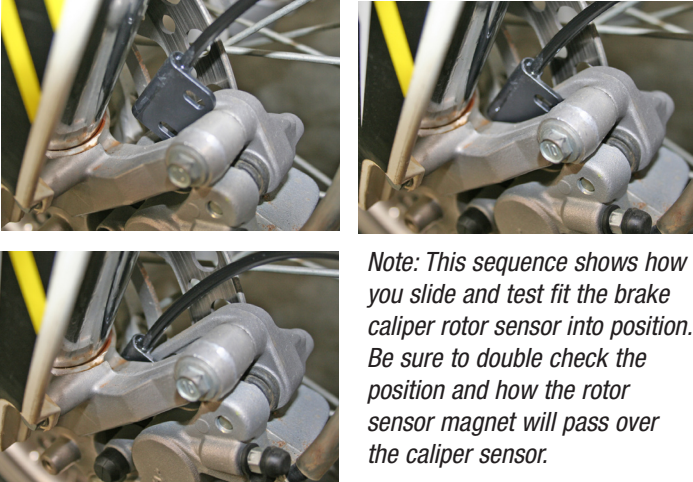

**Figure A**

**Step 2.** The speedometer magnet sensor on the rotor, passes over the caliper mounted sensor providing the pick-up signal to the speedometer. After you have defined the location of the rotor sensor, you will need to scribe a location on the rotor using a marker. Repeat this visual inspection for the brake caliper mounted sensor double checking the alignment of the sensors and scribe or indicate a position reference mark on the caliper. **See Figure B.**

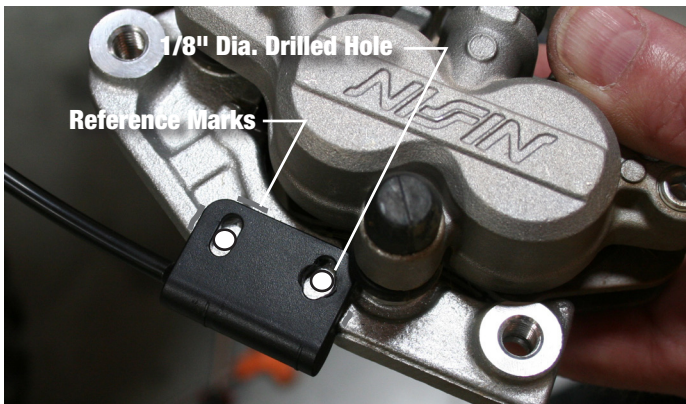

**Figure B**

**Step 3.** The brake caliper must be removed to install the sensor and to make the installation easier. Position the sensor on your marks similar to the position shown in Figure B. With the sensor firmly held in place, insert a marker through the mounting holes on the sensor and mark the drill hole locations. Remove the sensor and drill a 1/8" hole through the caliper mount. It is suggested to use a new drill bit during this procedure. Attach the sensor to the caliper with the screws provided.

### Brake Rotor Magnet Installation

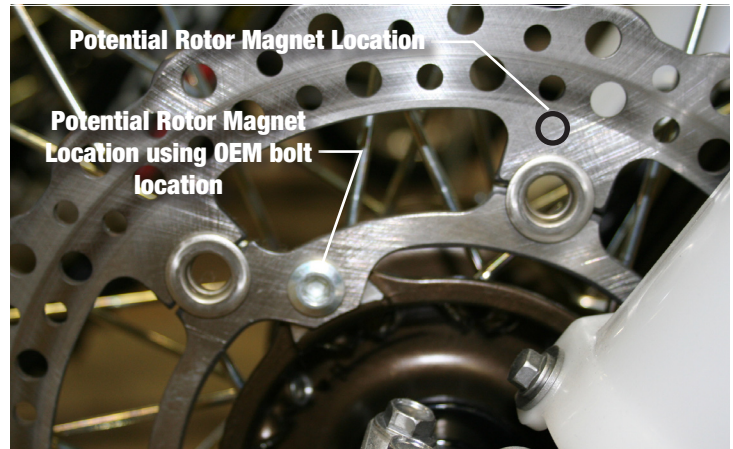

**Figure C**

**IMPORTANT NOTE:** if you need to use just the magnet, then you will need to glue it onto the rotor, the kit comes with two bolts one of which is a replacement for a rotor bolt, and then a small round magnet

**Step 4.** As most rotor shapes differ from manufacture to manufacture it is critical to insure the proper location of the rotor magnet before you adhering the magnet to the rotor. Be sure to double check this before proceeding. As shown in Figure C. Once you have confirmed this, you may find that you can simply replace one of the rotor mounting bolts with the supplied magnet rotor bolt. Depending on your set-up either use the rotor mounting bolt location or glue the "Flat" magnet in place. Do not over tighten the rotor mounting magnet bolt. 10 ft-lb is the standard specification.

**Step 5.** After you have finished mounting both sensors, reattach the brake caliper and check the magnet pass-over clearance. If your alignment and positions are correct, tighten down everything to the torque settings provided in your service manual. Continue by installing your AceWell speedometer and attaching your sensor cable!